



INSTALLATION INSTRUCTIONS

AWNING BRACKET AND KIT

FIRST TIME INSTALLATION

- Please read instructions carefully before installation.
- Check the contents of kit. Contact your Ironman 4x4 dealer if any parts appear missing or damaged.
- Place these instructions in the vehicle's glove box after installation is complete.

IMPORTANT:

- It is critical that all Ironman accessories be properly and securely attached to your vehicle. Improper attachment could result in an automobile accident, and could cause serious bodily injury or death to you or to others.
- You are responsible for securing the racks and accessories to your car, checking the attachments prior to use, and periodically inspecting the products for adjustment, wear, and damage. Therefore, you must read and understand all of the instructions and cautions supplied with your Ironman product prior to installation or use.
- If you do not understand all of the instructions and cautions, or if you have no mechanical experience and are not thoroughly familiar with the installation procedures, you should have the product installed by a professional installer such as a boat carrier specialist.



TOOLS REQUIRED:

- 3 mm Drill Bit
- 6 mm Drill Bit
- Vacuum Cleaner
- Small paint brush
- 3 mm Allen Key
- Power or Cordless Drill
- Mastic Silicone Sealant

KIT CONTENTS

ITEM	COMPONENT	QTY	ITEM	COMPONENT	QTY
1.	Awning Bracket	X2	6.	M8 x 25 Socket Head Capscrew	X4
2.	M8 Spring Nut	X4	7.	M8 x 20 Socket Head Capscrew	X4
3.	M8 20 x 20 x 3 Nut Tee	X4	8.	M6 x 20 Set Screw	X4
4.	M8 Washer	X8	9.	M6 x 12.5 x 1.5 mm Washer	X4
5.	M8 Spring Washer	X4	10.	M6 Nyloc Nut	X4

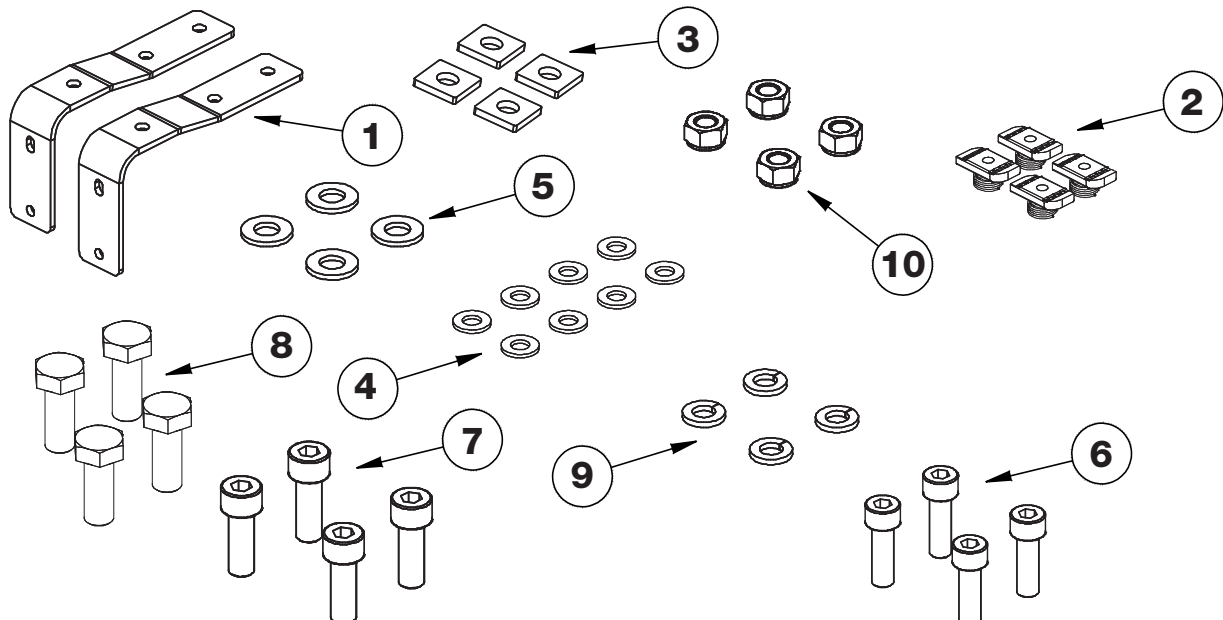

INSTALLATION FOR LOCKNLOAD AND HD BARS

- 1** Insert 2 x M8 Spring Nuts at an equal distance from the ends of a pair of crossbars on the same side of the vehicle. Push Spring Nuts down into the crossbar channels and twist to lock into place as pictured.

Use the Awning Brackets to ensure Spring Nuts align with holes on the Awning Brackets.

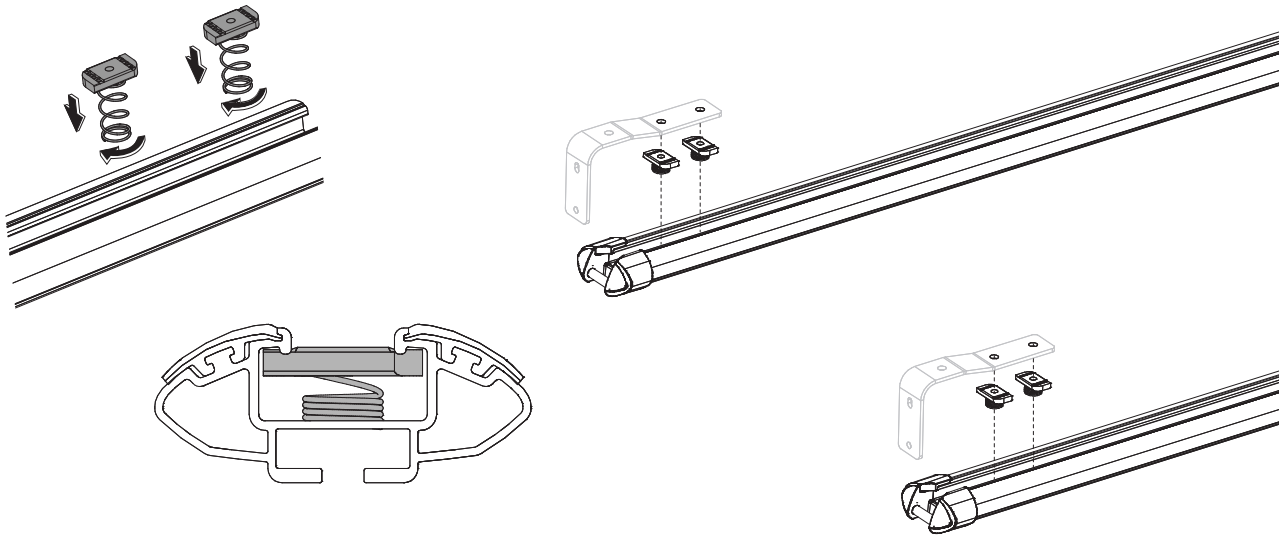

- 2a** Noting the orientation of the Awning Brackets as pictured, check that Awning will not interfere with opening doors once fitted. If there is not enough clearance use the alternative orientation of the Awning Brackets. If there is enough clearance, secure the 2 x Awning Brackets to the M8 Spring Nuts in the Crossbars by referring to Figure 1. Tighten to 4 Nm with a 6 mm Allen Key or a suitable Torque Wrench.

Fig. 1

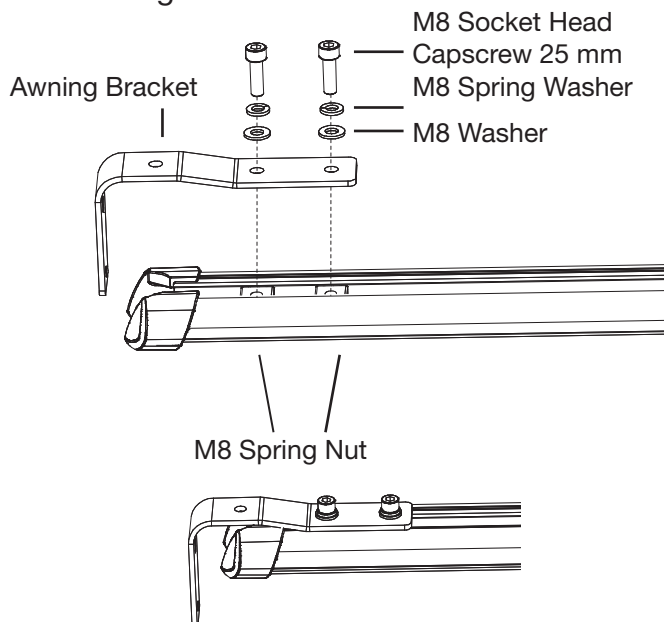

Alternative Awning Bracket Orientation

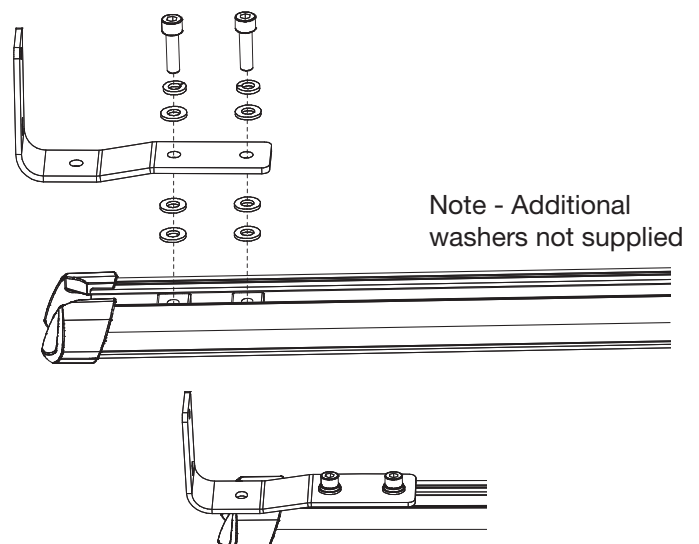

IF INSTALLING THE RECOVERY TRACKS HOLDER (SOLD SEPARATELY) OR ACCESSORY MOUNT BRACKETS (SOLD SEPARATELY) IN TANDEM WITH YOUR AWNING BRACKETS

- 2b** Secure the bracket from a Recovery Tracks/Accessory Mount Brackets kit to the top of each Awning Bracket with the M8 Spring Nuts in the platform slat channels by referring to Figure 2.

Tighten to 4 Nm with a 6 mm Allen Key or a suitable torque wrench.

Fig. 5

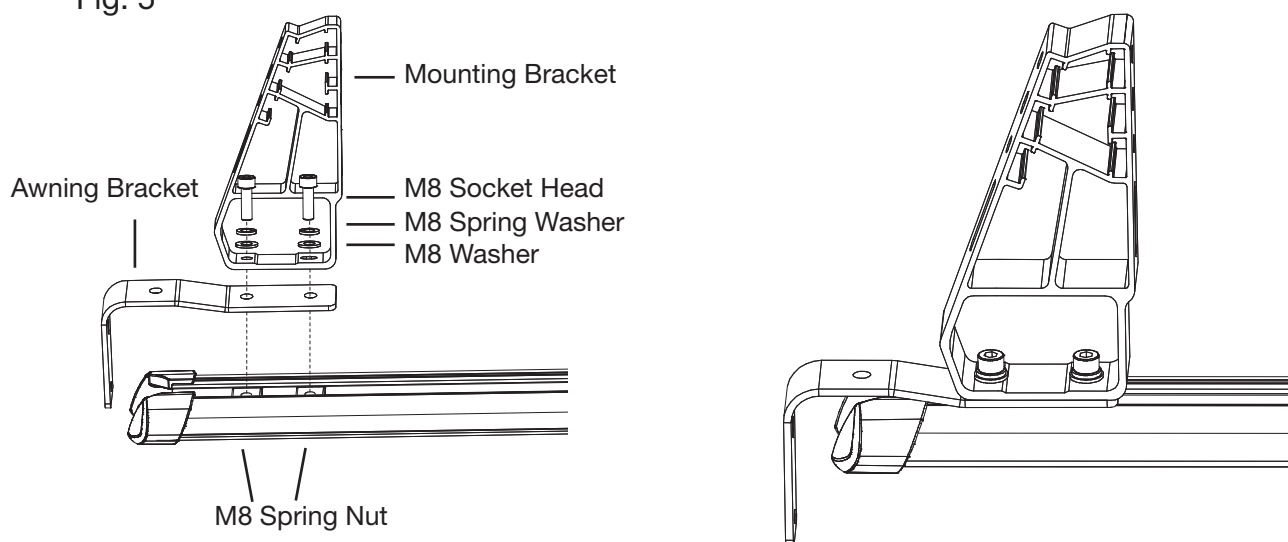

- 2c** Recovery Tracks and other accessories can be fitted to these Brackets as shown. Refer to the instructions supplied with these kits for more information.

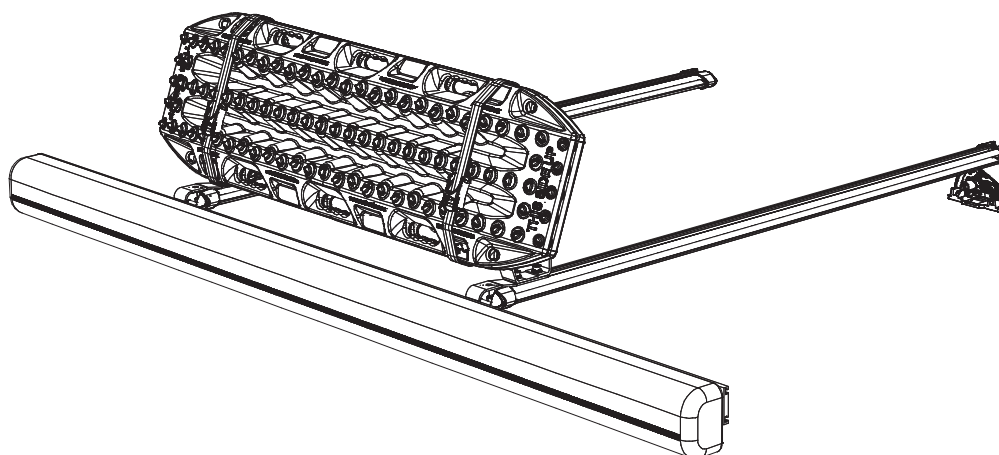

FOR AWNING MOUNTING INSTRUCTIONS, PROCEED TO STEP 7 ON PAGE 8

INSTALLATION AWNING BRACKETS TO LOCKLOAD PLATFORM

- 3** Insert two(2) sets of 2 x M8 Spring Nuts at an equal distance from platform side into the Platform slot cut outs. The Spring Nuts do not need to be rotated into position. An Allen Key can be used to move nuts within platform slot channels.

Use the Awning Brackets to ensure Spring Nuts align with holes on the Awning Brackets. It is best to space Brackets as far apart as practical on platform.

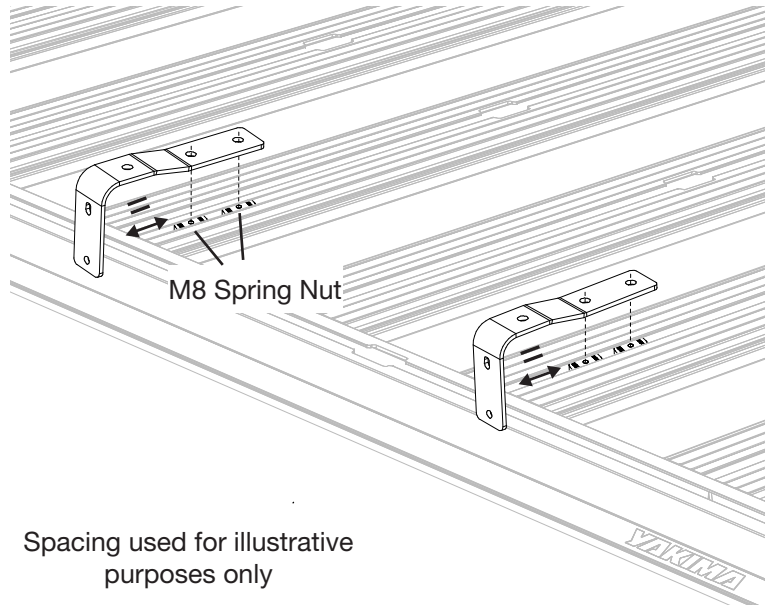
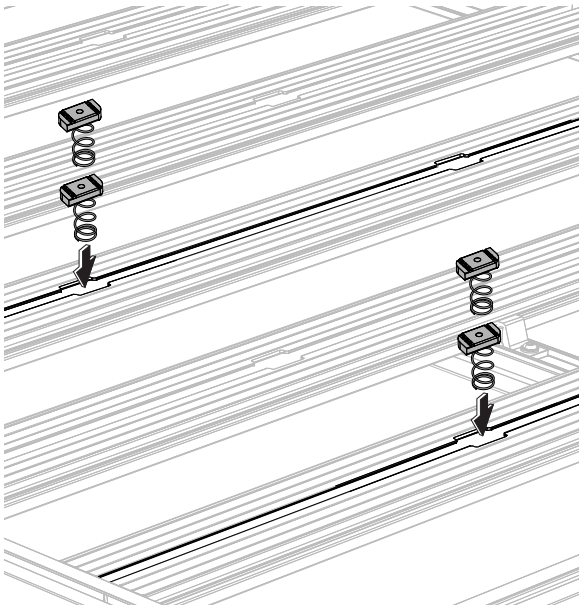

- 4a** Secure the 2 x Awning Brackets to the M8 Spring Nuts in the platform slot channels by referring to Figure 1.

Tighten to 4 Nm with a 6 mm Allen Key or a suitable Torque Wrench.

Fig. 1

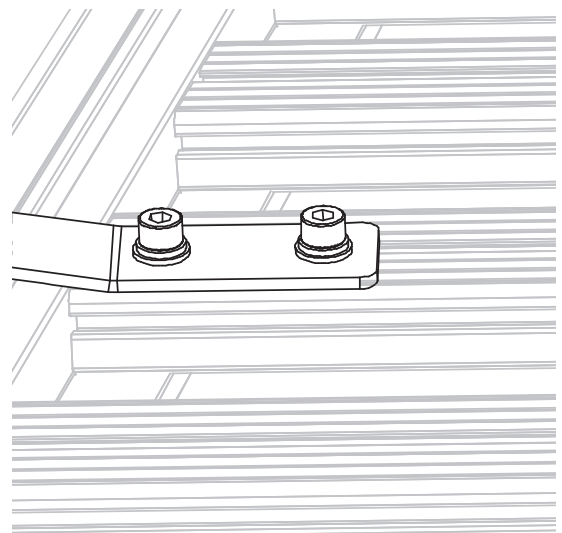
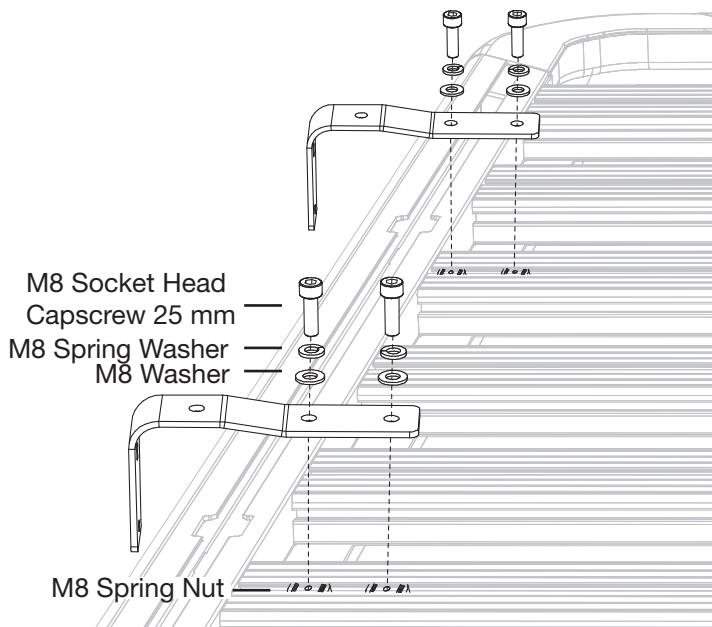

IF INSTALLING THE RECOVERY TRACKS HOLDER (SOLD SEPARATELY) OR ACCESSORY MOUNT BRACKETS (SOLD SEPARATELY) IN TANDEM WITH YOUR AWNING BRACKETS

4b

Secure the bracket from a Recovery Tracks/Accessory Mount Brackets kit to the top of each Awning Bracket with the M8 Spring Nuts in the platform slat channels by referring to Figure 2.

Tighten to 4 Nm with a 6 mm Allen Key or a suitable torque wrench.

Fig. 2

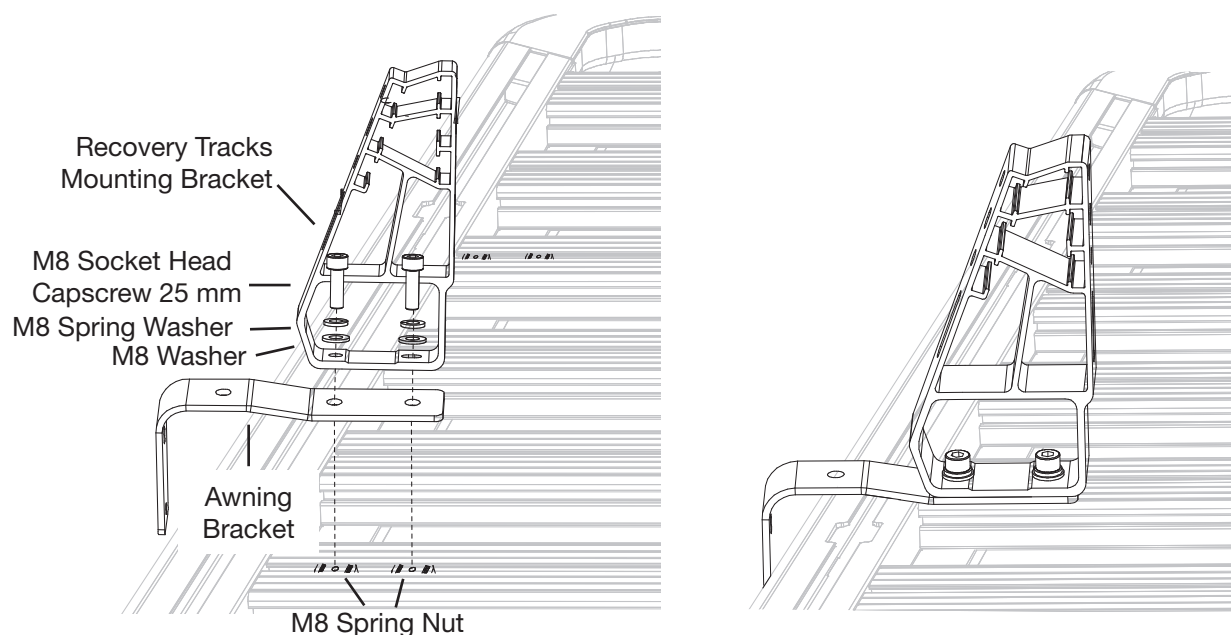

4c

Recovery Tracks and other accessories can be fitted to these Brackets as shown.

Refer to the instructions supplied with these kits for more information.

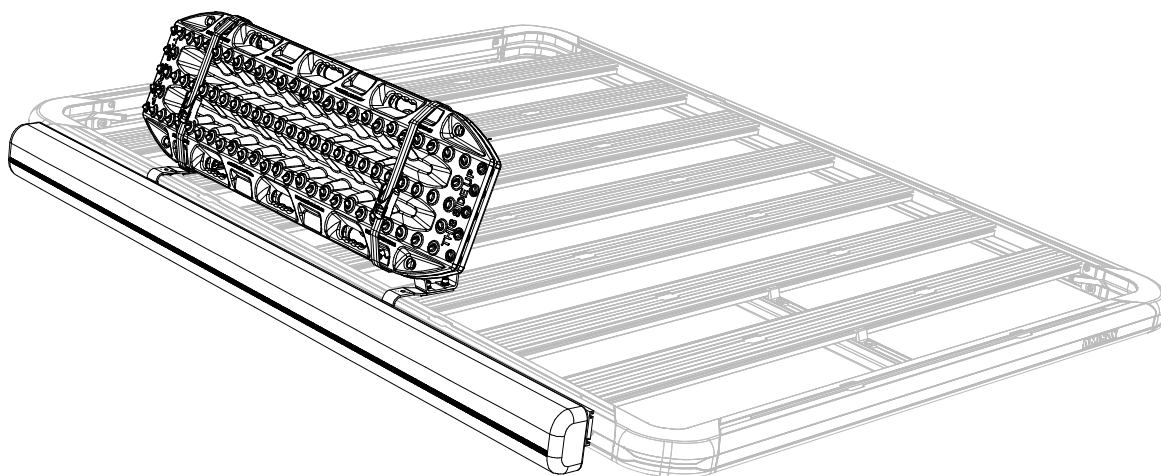

FOR AWNING MOUNTING INSTRUCTIONS, PROCEED TO STEP 7 ON PAGE 8

INSTALLATION ON S-WING AND INTERNATIONAL T-SLOT CROSSBARS

5

Push rubber infill down and slide 2 x M8 T-Nuts into each channel at an equal distance from the ends of a pair of crossbars on the same side of the vehicle. The 6mm Alley key can be used to assist T-Nut installation into the channel.

Use the Awning Brackets to ensure T-Nuts align with holes on the Awning Brackets.

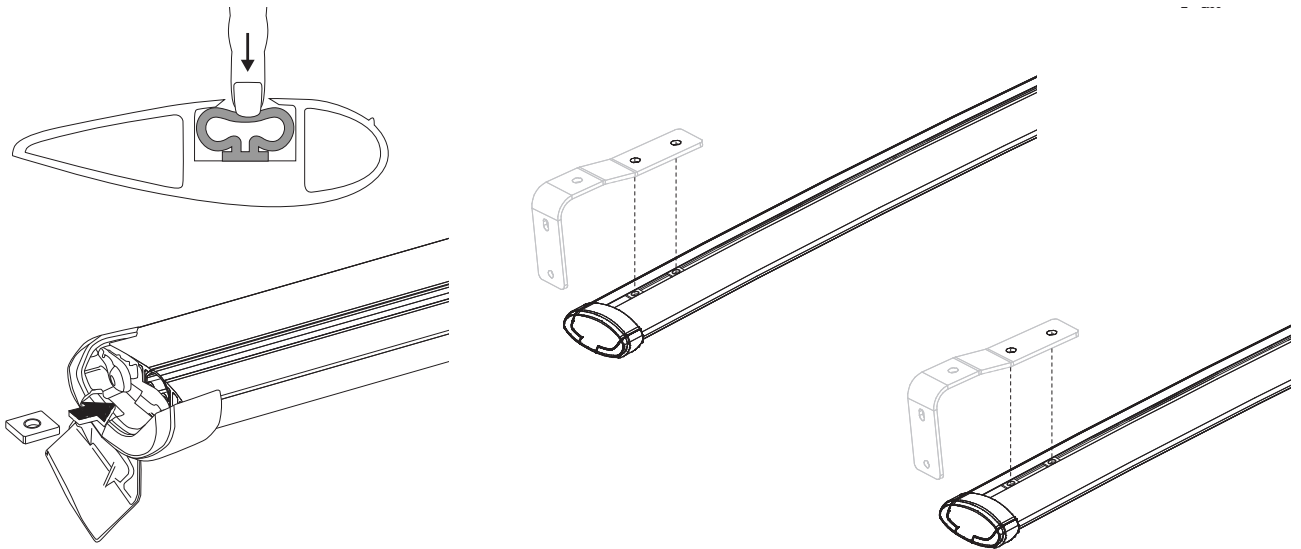

6a

Noting the orientation of the Awning Brackets as pictured, check that Awning will not interfere with opening doors once fitted. If there is not enough clearance use the alternative orientation of the Awning Brackets. If there is enough clearance, secure the 2 x Awning Brackets to the M8 T-Nuts in the Crossbars by referring to Figure 3. Tighten to 4 Nm with 6 mm Allen Key provided or a suitable Torque Wrench.

Fig. 3

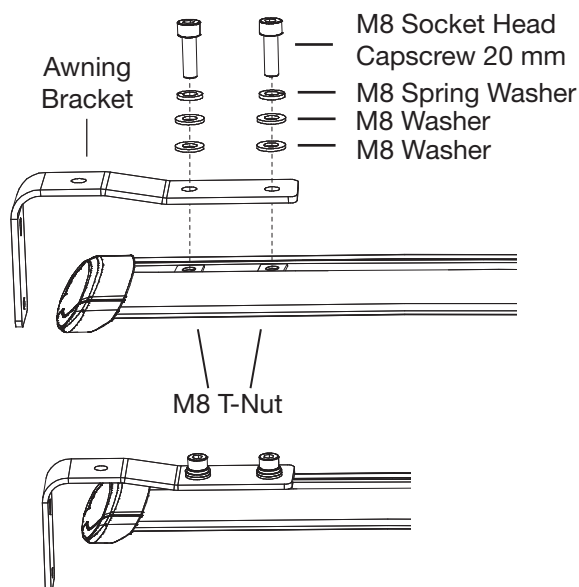

Alternative Awning Bracket Orientation

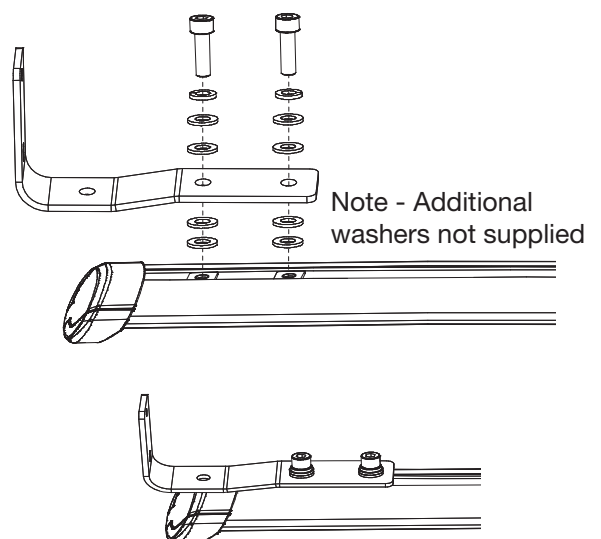

IF INSTALLING THE RECOVERY TRACKS HOLDER (SOLD SEPARATELY) OR ACCESSORY MOUNT BRACKETS (SOLD SEPARATELY) IN TANDEM WITH YOUR AWNING BRACKETS

- 6b** Secure the bracket from a Recovery Tracks/Accessory Mount Brackets kit to the top of each Awning Bracket with the M8 Spring Nuts in the platform slat channels by referring to Figure 2.
Tighten to 4 Nm with a 6 mm Allen Key or a suitable torque wrench.

Fig. 5

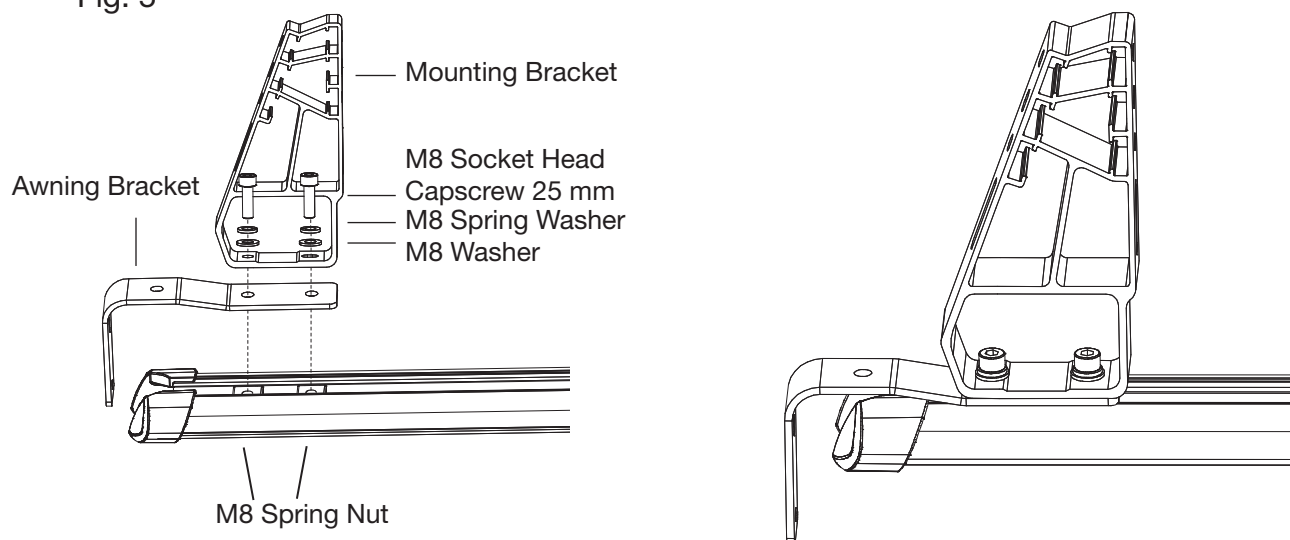

- 6c** Recovery Tracks and other accessories can be fitted to these Brackets as shown.
Refer to the instructions supplied with these kits for more information.

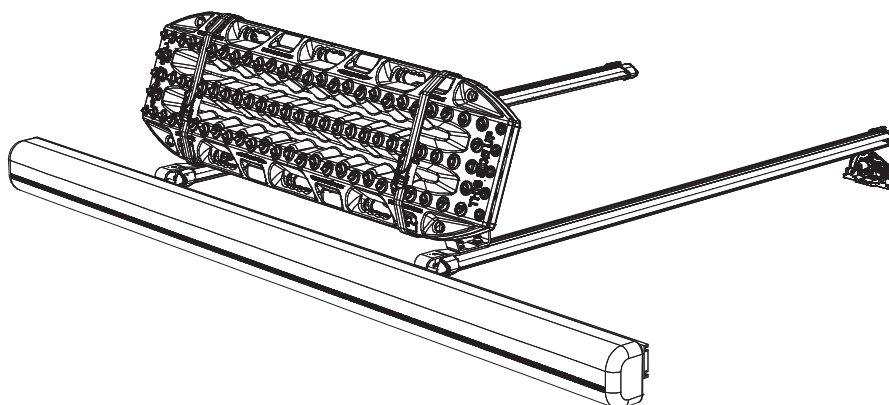

FOR AWNING MOUNTING INSTRUCTIONS, PROCEED TO STEP 7 ON PAGE 8

SHADE AWNING MOUNTING INSTRUCTIONS

7

Measure the distance of the centre of the holes in the Awning Brackets between each crossbar.

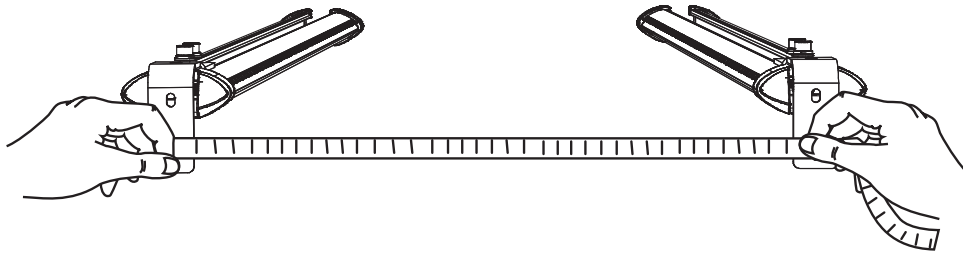

8

Slide 2 x M6 Hex Bolts into the top channel and 2 x M6 Hex Bolts into the bottom channel of the mounting extrusion on the rear of the awning.

Once all four bolts have been placed into the extrusion, use the measurement from the previous step to position the bolts so that they align with the holes on the Awning Brackets.



9

Referring to Figure 2, secure each M6 Hex Bolt to the Awning Brackets using 1 x M6 Washer and 1 x M6 Nylock Nut. Tighten all bolts to 4 Nm with a 10 mm Spanner or a suitable Torque Wrench.

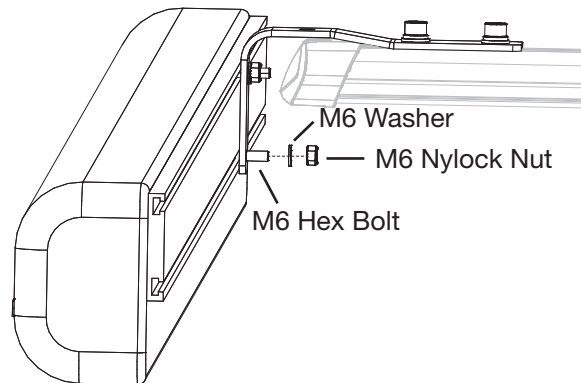

10

Your awning is now fitted and ready for use. Please refer to your awning's set up instructions for use.

