

IRONMAN 4x4
DELTA WING ENSUITE

IENSUITEXT

**Deltawing
Ensuite
Owner's Manual**

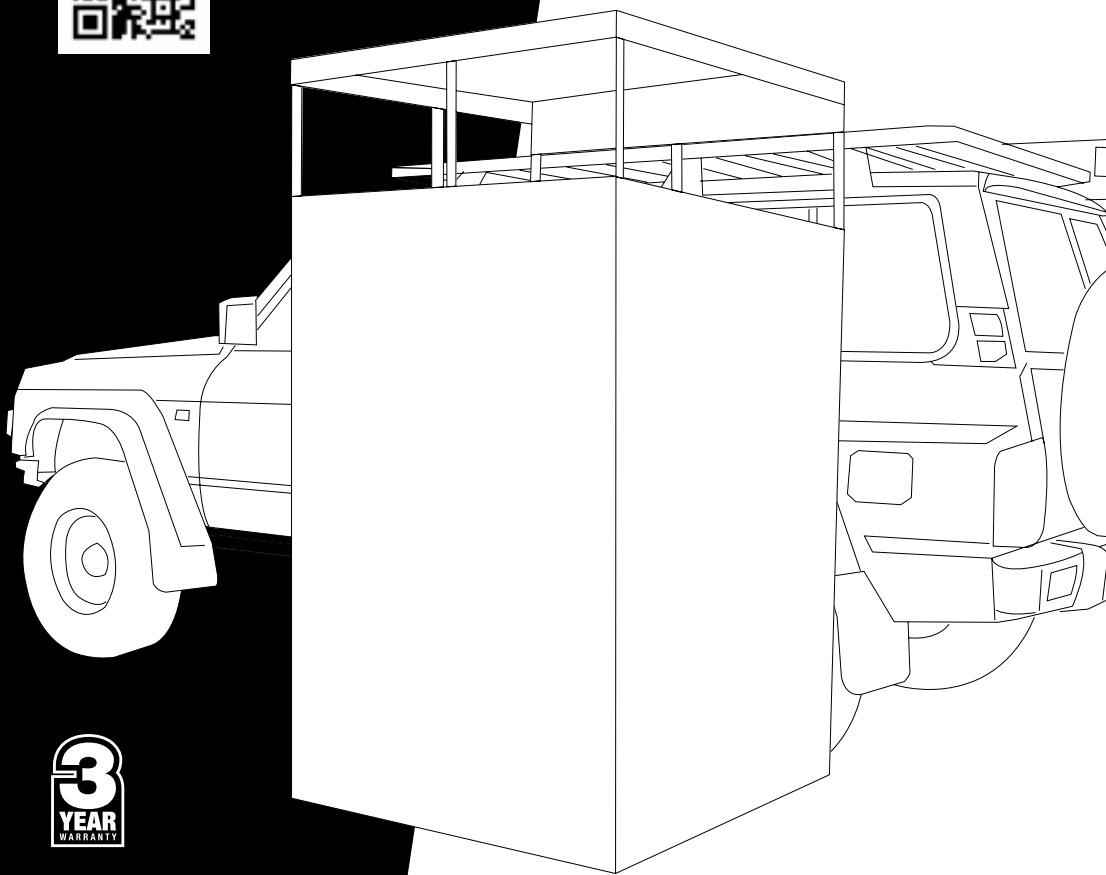

IMPORTANT: Please read all procedures and precautions before using this Ironman 4x4 Product.
If you have any questions please contact our customer service department.

Safety Warnings

WARNING

Incorrect installation or use of your ensuite could result in serious injury or death. Please follow these instructions carefully to ensure proper installation on your vehicle and correct operation.

We recommend contacting your vehicle or accessory manufacturer for specified load capacity of your roof and roof rack. Not all factory or aftermarket roof racks or bars can safely accommodate all rooftop accessory additions.

Accessory inclusions such as awnings and ensuites can change normal vehicle handling. Ironman 4x4 disclaims all responsibility in case of accident due to incorrect installation, improper use or maintenance and infrequent review of fasteners tensions.

INSPECTIONS

All bolts and fixings associated with the installation of an ensuite arm to mounting brackets **MUST BE** secure and not loose prior to installation or after use.

- If left unchecked this may result in some cases where bolts could work loose, causing the ensuite arms to improperly deploy, resulting in incorrect operation and/or failure of the product.
- Regular inspection of all mounts and fixings is recommended to ensure continuous, correct operation. Prolonged use on rough and corrugated terrain will require more regular inspections.

STRUCTURAL INTEGRITY:

The Deltawing Ensuite is self-supporting and designed for general camping under normal conditions. We recommend the supplied pegs are used to provide additional support when in use.

- This ensuite is designed to be used during calm conditions. Avoid setting up in strong winds.
- In windy or stormy conditions always ensure guy ropes are secured and anchored correctly.
- To avoid the chance of damage or injury, we recommend your ensuite should not be erected during windy conditions. Damage caused by incorrect installation or operation during adverse weather conditions will not be covered by warranty.
- Failure to follow these instructions may result in serious personal injury, damage to equipment or vehicles and negate any warranty claim.

SAFETY WARNING

- KEEP ALL FLAME AND HEAT SOURCES AWAY FROM ENSUITES, AWNINGS AND WALL MATERIALS. UNDER NO CIRCUMSTANCE SHOULD ANY NAKED FLAME SOURCES OR HEATING DEVICES BE USED INSIDE OR NEAR AN ENSUITE.
- DO NOT USE ANY FUEL BURNING DEVICE INSIDE AN ENSUITE. ALWAYS KEEP THE EXIT CLEAR.

Notes and Parts

DELTA WING ENSUITE

Congratulations on your purchase of the Ironman 4x4 Deltawing Ensuite.

Your ensuite is designed to be mounted directly to your roof rack or aftermarket roof bars and can be set up in just a few minutes.

The Deltawing Ensuite is made using the best possible materials and construction methods, providing excellent protection from the elements.

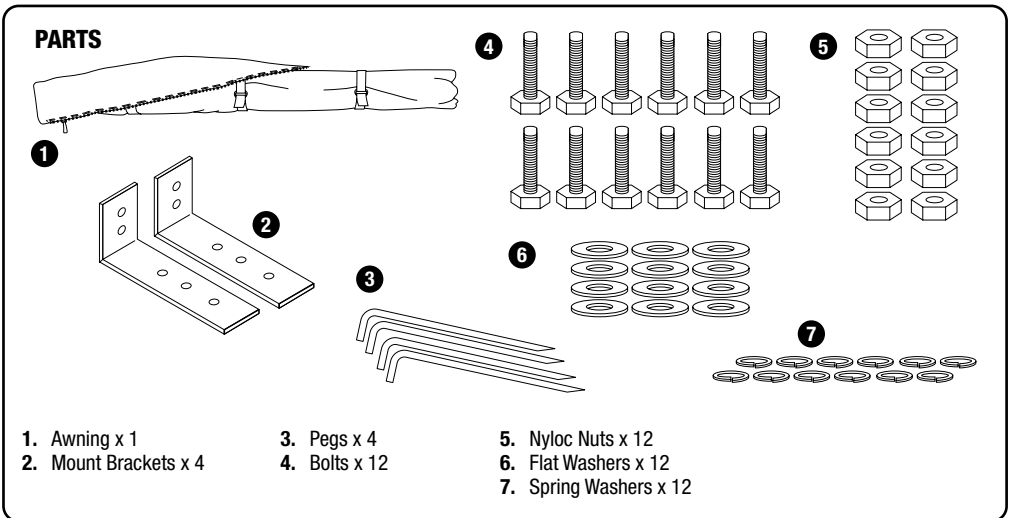

CLEANING AND STORAGE

- Use cold water with a soft bristle brush, **DO NOT** use soaps, bleaches, or any other abrasive cleaners as this may result in damage to the fabric.
- Avoid storing your ensuite when wet or damp. If conditions dictate that you have to, open and dry out as soon as possible to avoid moisture damage.

Locating Ensuite on Your Vehicle

We recommend your ensuite is assembled and installed by two (2) persons, further recommendations would be to have your ensuite installed by an experienced 4x4 accessory installer.

The ensuite brackets supplied have been designed to fit the most common configurations of roof racks and rail systems, however due to the ever-increasing variations being offered by vehicle and accessory manufacturers, it cannot be 100% guaranteed that these will fit all available options.

We recommend speaking with your roof rack specialist for further advice or recommendations on the best system for your requirements.

ENSURE the minimum spacing between the mounting brackets is 1200mm to allow the awning to be supported correctly and weight is evenly distributed.

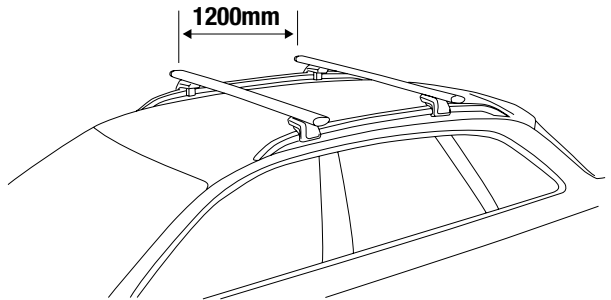

Step 1:

Insert and slide bolt heads into the backing plate track.

Step 2:

Align short leg of bracket holes over the bolts.

Step 3:

Attach washers and loosely secure in place using Nyloc nuts.

Step 4:

Slide brackets along the backing plate track to the desired position and mount to the vehicle using washers and Nyloc nuts. Tighten all nuts.

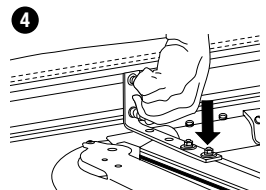
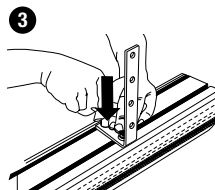
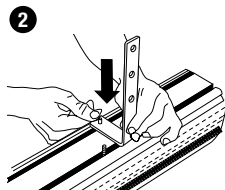
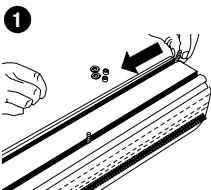

Setting Up Your Ensuite

Step 1:

Unzip the protective cover and fold back from the ensuite.

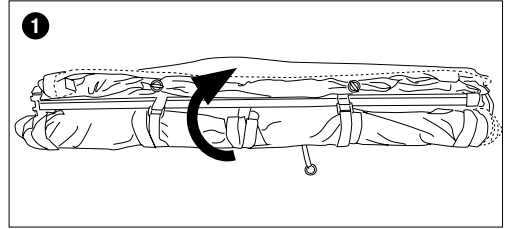

Step 2:

Undo the Velcro straps, releasing the fabric and carefully allowing to roll down.

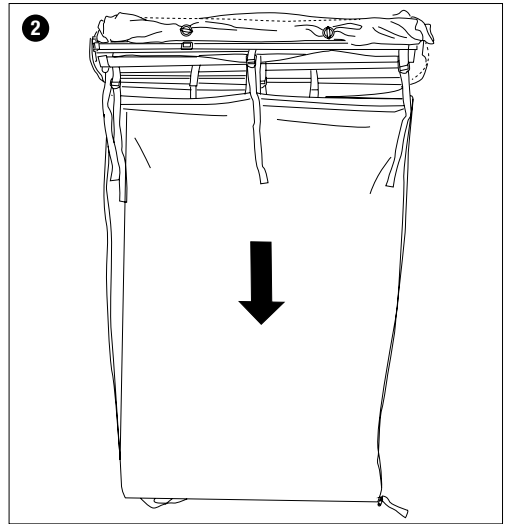

Step 3:

Swing the upper arm from the ensuite body to the left. Lock the arm into place at 90° to the ensuite body.

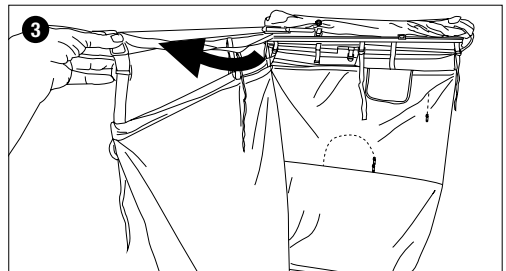

Setting Up Your Ensuite

Step 4:

Carefully swing the other arm out to the right, forming a cube shape. Lock the arm into place at 90° to the ensuite body.

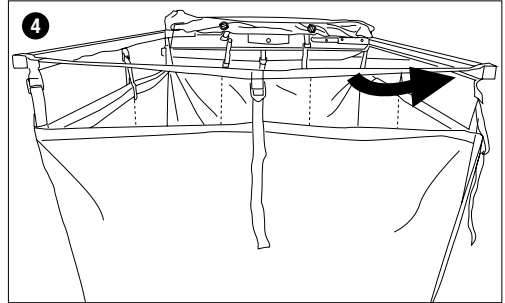

Step 5:

Undo the eyelets tie straps securing the roof in place. Roll fabric out and carefully fit over the two extended arms.

Secure each side of the roof around both arms with integrated Velcro straps.

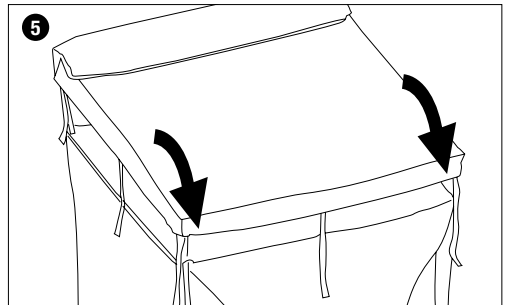

Step 6:

Determine the height you require for privacy and lengthen or shorten the cam-lock straps to suit.

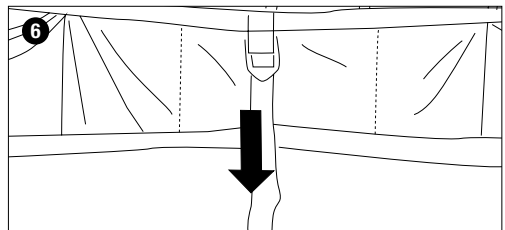

Step 7:

Secure the base at all four (4) corners through the loops at the base using pegs supplied.

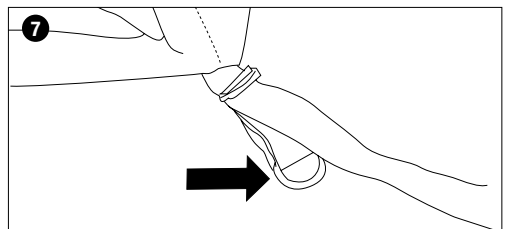

Packing Up Your Ensuite

Step 1:

If time permits, allow the ensuite material to fully dry out before packing away.

If this is not possible, we strongly suggest setting the ensuite up again to thoroughly dry out before any long-term storage to prevent damage to the material and mechanisms.

Remove pegs and close all ensuite zips.

Step 2:

Remove the roof from the arms and roll up tightly. Secure with integrated eyelet tie straps.

Step 3:

Pull forward slightly to release right-hand side arm lock.

Fold arm in toward ensuite body, collapsing the right-hand corner of the ensuite back toward the left-hand side corner.

Step 4:

Release left-hand side arm lock and fold arm in toward ensuite body.

Step 5:

Starting at the bottom, tightly roll the material upwards and secure in place with the integrated Velcro straps.

Step 6:

Pull the protective cover back over the entire unit and zip up. Be careful not to catch the ensuite material in the zip.

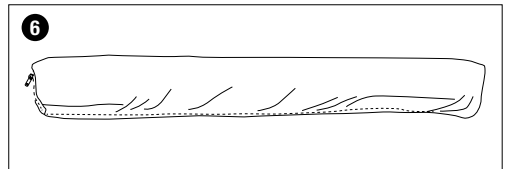
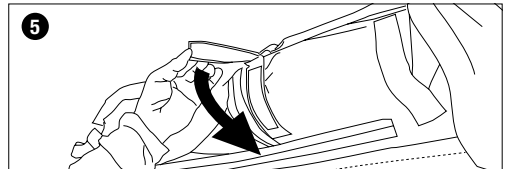
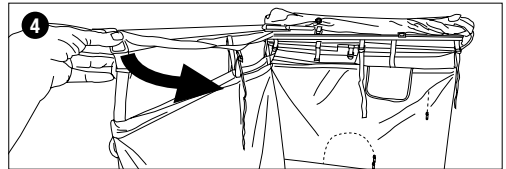
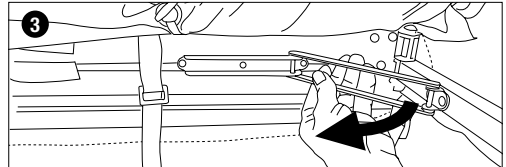
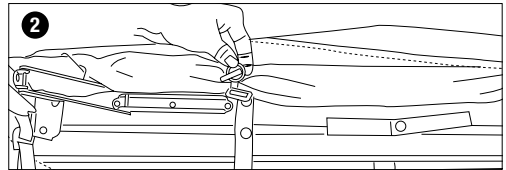
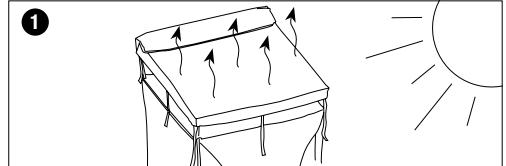

WARRANTY

The offered 3 year warranty is limited to manufacturing and material defects. Not including; damage caused by misuse or abuse, wear and tear, condensation, extreme weather, accidents, incorrect set up, damage caused by being stored whilst damp. It also excludes broken poles and damage caused by a jammed, snagged zipper or excessive force applied to a zipper, causing failure.



This product is not designed to be used as a permanent shelter or used in commercial applications. As such, any claims for warranty may be reviewed subject to the conditions of use and appearance when presented.

IMPORTANT INFORMATION

Ironman 4x4 is not liable for any or accident that may occur as a result of non-compliance with these instructions, modifications made to any part, or the use of any parts other than manufacturer original parts.

The warnings, cautions and instructions for use contained in this document cannot cover every possible situation, so it is understood by the operator that common sense and caution must be applied. It is your responsibility to pass these instructions on to any third party who uses this product, including second-hand sales.